



Universal Lathe Chucks

Cast Iron – 3-Jaw, Solid and 2-Piece Jaws & 4-Jaw, 2-Piece Jaws – Front Mount Self-Centering

LATHE CHUCKS & ACCESSORIES

These 3 and 4-Jaw Universal Scroll Chucks are designed for use with rotary tables and other devices where back mounting chucks cannot be used. They can be mounted directly on 3-slot rotary table or on base plate when rotary table has 4 or 8 T-slots.

3-Jaw – Series 3274 & Series 3275

- Cast iron
- Ground working surfaces
- Flexible mounting system: mounting from the back or front of the chuck by use of an adapter plate

Standard Accessories – Series 3274:

- 1 set of hard solid ID jaws
- 1 set of hard solid OD jaws
- 1 wrench

Standard Accessories – Series 3275:

- 1 set of hard top jaws
- 1 set of hard master jaws
- 1 wrench

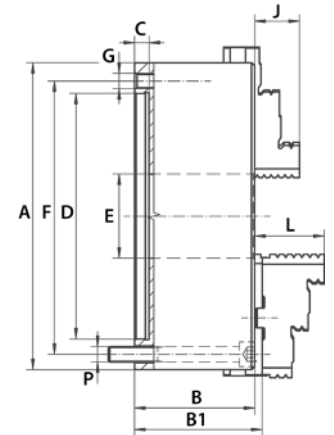

A (Inch)	B (Inch)	B1 (Inch)	C (Inch)	DH7 (Inch)	E (Inch)	F (Inch)	G	J (Inch)	L (Inch)	P	Solid Jaws Series 3274		2-Piece Jaws Series 3275	
											Weight (lbs)	Code	Weight (lbs)	Code
3.94	1.97	-	0.12	2.76	0.79	3.27	3 x M8	0.63	-	3 x 5/16-18	6.17	355275	-	-
4.92	2.20	2.39	0.16	3.74	1.26	4.25	3 x M8	0.79	1.57	3 x 5/16-18	-	-	11.02	355279
6.30	2.54	2.73	0.16	4.92	1.65	5.51	3 x M10	1.26	1.69	3 x 3/8-16	-	-	22.05	355280
7.87	2.95	3.14	0.16	6.30	2.17	6.93	3 x M10	1.14	1.77	3 x 3/8-16	38.58	355276	38.58	355281
9.84	3.35	3.50	0.20	7.87	2.99	8.82	3 x M12	1.34	2.09	3 x 1/2-13	63.93	355277	63.93	355282
12.40	3.70	3.90	0.20	10.24	4.06	11.26	3 x M16	1.69	2.24	3 x 5/8-11	110.23	355278	110.23	355283

4-Jaw – Series 3675

- Cast iron
- Ground working surfaces
- Flexible mounting system: mounting from the back or front of the chuck by use of an adapter plate

Standard Accessories:

- 1 set of hard top jaws
- 1 set of hard master jaws
- 1 wrench

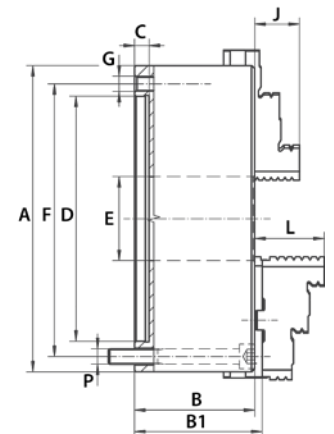

A (Inch)	B (Inch)	B1 (Inch)	C (Inch)	DH7 (Inch)	E (Inch)	F (Inch)	G	J (Inch)	L (Inch)	P	2-Piece Jaws Series 3675	
											Weight (lbs)	Code
4.92	2.20	2.39	0.16	3.74	1.26	4.26	3 x M8	0.79	1.57	3 x 5/16-18	11.02	355284
6.30	2.54	2.73	0.16	4.92	1.65	5.51	3 x M10	1.26	1.69	3 x 3/8-16	22.05	355285
7.87	2.95	3.14	0.16	6.30	2.17	6.93	3 x M10	1.14	1.77	3 x 3/8-16	38.58	355286
9.84	3.35	3.50	0.20	7.87	2.99	8.82	3 x M12	1.34	2.09	3 x 1/2-13	63.93	355287
12.40	3.70	3.90	0.20	10.24	4.06	11.26	3 x M16	1.69	2.24	3 x 5/8-11	110.23	355288