

Precision Lathe Chucks & Accessories



PO Series – Forged Steel Body – 3-Jaw Self-Centering Chucks

2 Pc. Hard Reversible Jaws (*continued*)

Camlock Mounting

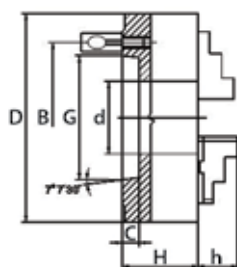

LATHE CHUCKS & ACCESSORIES

Chuck Diameter (Inch)	d Hole Diameter (Inch)	RPM Maximum	Model	B (Inch)	C (Inch)	G (Inch)	H (Inch)	h (Inch)	Camlock Stud Diameter (Inch)	Camlock Stud Thread	No. of Bolts	Code
6	1.65	4500	PO3-6"A/DI-3	2.75	0.51	2.12	2.68	1.69	0.56	M10 x 1.0	3	356361
6	1.65	4500	PO3-6"A/DI-4	3.25	0.51	2.50	2.68	1.69	0.62	M10 x 1.0	3	356362
6	1.65	4500	PO3-6"A/DI-5	4.13	0.56	3.75	2.68	1.69	0.75	M12 x 1.0	6	356363
8	2.17	4000	PO3-8"A/DI-5	4.13	0.56	3.25	3.07	1.77	0.75	M12 x 1.0	6	356364
8	2.17	4000	PO3-8"A/DI-6	5.25	0.63	4.19	3.07	1.77	0.87	M16 x 1.5	6	356365
10	2.99	3500	PO3-10"A/DI-6	5.25	0.63	4.19	3.50	2.09	0.87	M16 x 1.5	6	410055
10	2.99	3500	PO3-10"A/DI-8	6.75	0.71	5.50	3.50	2.09	1.00	M20 x 1.5	6	410056
12	4.06	2800	PO3-12"A/DI-6	5.25	0.63	4.19	3.79	2.24	0.87	M16 x 1.5	6	410057
12	4.06	2800	PO3-12"A/DI-8	6.75	0.71	5.50	3.79	2.24	1.00	M20 x 1.5	6	410058
12	4.06	2800	PO3-12"A/DI-11	9.25	0.79	7.75	4.40	2.24	1.19	M22 x 1.5	6	356366
16	5.35	2000	PO3-16"A/DI-8	6.75	0.71	5.50	4.26	2.64	1.00	M20 x 1.5	6	356367
16	5.35	2000	PO3-16"A/DI-11	9.25	0.79	7.75	4.26	2.64	1.19	M22 x 1.5	6	356368
20	7.60	1200	PO3-20"A/DI-11	9.25	0.79	7.75	4.68	3.15	1.19	M22 x 1.5	6	356369
25	7.48	1000	PO3-25"A/DI-11	9.25	0.79	7.75	5.08	3.42	1.19	M22 x 1.5	6	356370

Spare Jaws for PO Series

Hard jaws, supplied as supplement or as spares, must be ground on the chuck, otherwise centering accuracy does not conform the limits

Hard Top Jaws – 3-Piece Sets

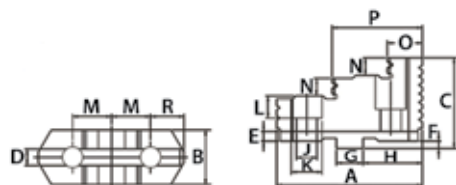

For Chuck Diameter (Inch)	B (Inch)	C (Inch)	D (Inch)	E (Inch)	F (Inch)	G (Inch)	H (Inch)	J (Inch)	K (Inch)	M (Inch)	N (Inch)	A OAL (Inch)	O (Inch)	P (Inch)	Weight (lbs)	Code
6	0.98	1.63	0.31	0.16	0.13	0.50	1.12	0.43	0.71	0.75	0.33	2.64	0.81	1.69	1.20	410140
8	1.18	1.77	0.31	0.16	0.13	0.50	1.37	0.43	0.71	0.87	0.41	3.35	0.98	2.09	2.10	410141
10	1.42	2.09	0.50	0.16	0.13	0.75	1.56	0.55	0.78	1.06	0.53	3.74	1.14	2.52	3.20	410142
12	1.65	2.28	0.50	0.16	0.13	0.75	1.87	0.55	0.78	1.25	0.69	4.25	1.22	3.01	5.10	410143
16	1.77	2.76	0.50	0.16	0.25	0.75	2.25	0.71	1.00	1.50	0.69	5.00	1.85	3.46	7.30	410144
20	1.98	3.42	0.50	0.16	0.25	0.75	2.25	0.87	1.30	1.50	0.79	5.16	2.05	3.23	14.40	410145
25	2.05	3.42	0.50	0.16	0.25	0.75	2.25	0.87	1.30	1.50	0.79	5.16	2.05	3.23	27.10	356302