

## Precision Lathe Chucks & Accessories



### PO Series – Forged Steel Body – 3-Jaw Self-Centering Chucks

#### 2 Pc. Hard Reversible Jaws

- Forged steel body, medium duty
- 3 pinion design

#### Each chuck is provided with:

- 1 set of hard master jaws
- 1 set of hard top reversible jaws
- 1 chuck wrench
- 1 set of mounting bolts
- 2 hex keys
- Eye bolts for chuck sizes larger than 10"

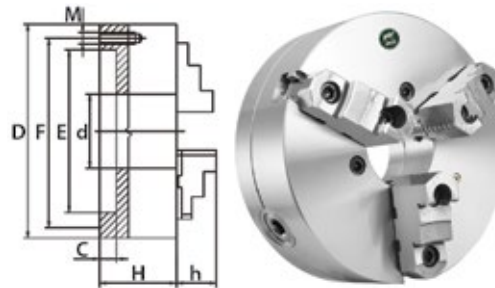

#### Plain Back Mounting

Chuck Diameter (Inch)	d Hole Diameter (Inch)	RPM Maximum	Model	C (Inch)	E (Inch)	F (Inch)	H (Inch)	h (Inch)	M Thread	Bolt Length (Inch)	No. of Bolts	Code
6	1.65	4500	PO3-6"A	0.16	4.92	5.51	2.76	1.69	M10 x 1.5	0.98	6	410048
8	2.17	4000	PO3-8"A	0.16	6.30	6.93	3.15	1.77	M10 x 1.5	0.98	6	410049
10	2.99	3500	PO3-10"A	0.20	7.87	8.82	3.54	2.09	M12 x 1.75	1.18	6	410050
12	4.06	2800	PO3-12"A	0.20	10.24	11.26	3.94	2.24	M16 x 2	1.18	6	410051
16	5.35	2000	PO3-16"A	0.20	12.99	14.25	4.33	2.69	M16 x 2	1.57	6	410052
20	7.48	1200	PO3-20"A	0.20	16.54	18.03	4.68	3.15	M16 x 2	1.57	6	410053
25	9.92	1000	PO3-25"A	0.28	21.46	23.07	5.08	3.42	M16 x 2	1.57	6	410054

#### Type A Mounting



Type A1/A2

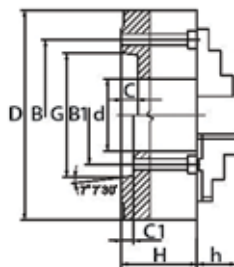

Chuck Diameter (Inch)	d Hole Diameter (Inch)	RPM Maximum	Model	B1 Type A1 (Inch)	B Type A2 (Inch)	* C/C1 (Inch)	G (Inch)	H (Inch)	h (Inch)	M Thread	Bolt Length (Inch)	No. of Bolts	Code
8	2.17	4000	PO3-8"A/A1-6	3.25	-	0.62	4.19	3.07	1.77	1-2/13	2.75	3	410059
10	2.17	3500	PO3-10"A/A1-6	3.25	-	0.62	4.19	3.50	2.09	1-2/13	3.12	6	410060
10	2.99	3500	PO3-10"A/A1-8	4.37	-	0.69	5.50	3.50	2.09	5/8-11	2.75	6	410061
12	4.06	2800	PO3-12"A/A2-6	-	5.25	0.63	4.19	3.79	2.24	1-2/13	4.00	6	410062
12	3.15	2800	PO3-12"A/A1-8	4.37	-	0.69	5.50	3.79	2.24	5/8-11	3.12	6	410063
16	5.12	2000	PO3-16"A/A1-11	6.5	-	0.75	7.75	4.25	2.64	3/4-10	4.50	6	410064
20	7.48	1200	PO3-20"A/A2-11	-	9.25	0.79	7.75	4.68	3.09	3/4-10	4.75	6	410065

\* C-C1 = depth of counterbore