

## Quick Change Tap Adapters

Morse Taper Shank – Tension/Compression

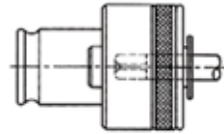
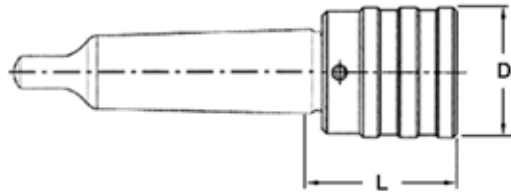

- For use on drills, lathes, etc.
- Takes Bilz style adapters #1, #2, and #3

Shank Size	Adapter	D (Inch)	L (Inch)	Code	Shank Size	Adapter	D (Inch)	L (Inch)	Code
MT2	CWE 1	1.42	1.85	242200	MT3	CWE 2	2.08	2.83	242205
MT3	CWE 1	1.42	1.85	242201	MT4	CWE 2	2.08	2.83	242206

## BILZ Style Tap Adapters

Positive Drive & Torque Control Tap Adapters – Inch & Metric

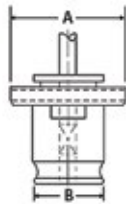

Model	A	B
CWE 1	1.18	0.75
CWE 2	1.89	1.22
CWE 3	2.75	1.89

Standard Positive Drive (PD) – Inch

Hand Tap Size	Tap Shank Diameter (Inch)	Model CWE 1		Model CWE 2		Model CWE 3	
		Depth Tap Enters	Code	Depth Tap Enters	Code	Depth Tap Enters	Code
0-6	0.141	0.85	356500	0.85	356540	-	-
#8	0.168	0.92	356502	0.92	356542	-	-
#10	0.194	0.92	356504	0.92	356544	-	-
#12	0.220	0.95	356506	0.95	356546	-	-
1/4"	0.255	0.95	356508	0.95	356548	-	-
5/16"	0.318	0.98	356510	1.49	356550	-	-
3/8"	0.381	1.05	356512	1.56	356552	-	-
7/16"	0.323	1.08	356514	1.59	356554	-	-
1/2"	0.367	1.11	356516	1.62	356556	-	-
9/16"	0.429	1.17	356518	1.68	356558	-	-
5/8"	0.480	-	-	1.74	356560	-	-
11/16"	0.542	-	-	1.81	356562	-	-
3/4"	0.590	-	-	1.87	356564	-	-
13/16"	0.652	-	-	1.87	356566	2.42	356580
7/8"	0.697	-	-	1.93	356568	2.48	356582
15/16"	0.760	-	-	-	-	2.48	356584
1"	0.800	-	-	-	-	2.54	356586
1-1/8"	0.896	-	-	-	-	2.61	356588
1-1/4"	1.021	-	-	-	-	2.73	356590
1-3/8"	1.108	-	-	-	-	2.79	356592

Pipe – Positive Drive (PD) – Inch

Pipe Tap Size	Tap Shank Diameter (Inch)	Model CWE 1		Model CWE 2		Model CWE 3	
		Depth Tap Enters	Code	Depth Tap Enters	Code	Depth Tap Enters	Code
1/8 SS	0.313	1.05	356520	-	-	-	-
1/8 LS	0.437	1.05	356522	-	-	-	-
1/4	0.562	-	-	1.18	356570	-	-
3/8	0.700	-	-	1.24	356572	-	-
1/2	0.687	-	-	1.37	356574	-	-
3/4	0.906	-	-	-	-	1.55	356596
1	1.125	-	-	-	-	1.68	356598