

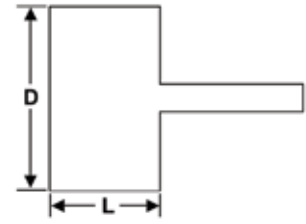

Mounted Flap Wheels

1/4" Shank



Size D x L (Inch)	Grit	RPM	Code	Size D x L (Inch)	Grit	RPM	Code	Size D x L (Inch)	Grit	RPM	Code
3/4 x 3/4	40	-	705180	1-1/2 x 3/4	240	18000	705246	2 x 1-1/2	60	17000	705321
3/4 x 3/4	60	-	705181	1-1/2 x 3/4	320	18000	705247	2 x 1-1/2	80	17000	705322
3/4 x 3/4	80	-	705182	1-1/2 x 1	40	18000	705260	2 x 1-1/2	120	17000	705323
3/4 x 3/4	120	-	705183	1-1/2 x 1	60	18000	705261	2 x 1-1/2	150	17000	705324
3/4 x 3/4	150	-	705184	1-1/2 x 1	80	18000	705262	2 x 1-1/2	180	17000	705325
3/4 x 3/4	180	-	705185	1-1/2 x 1	120	18000	705263	2 x 1-1/2	240	17000	705326
3/4 x 3/4	240	-	705186	1-1/2 x 1	150	18000	705264	2 x 1-1/2	320	17000	705327
3/4 x 3/4	320	-	705187	1-1/2 x 1	180	18000	705265	2-1/2 x 1/2	40	15000	705330
1 x 1	40	-	705190	1-1/2 x 1	240	18000	705266	2-1/2 x 1/2	60	15000	705331
1 x 1	60	-	705191	1-1/2 x 1	320	18000	705267	2-1/2 x 1/2	80	15000	705332
1 x 1	80	-	705192	2 x 3/8	40	17000	705270	2-1/2 x 1/2	120	15000	705333
1 x 1	120	-	705193	2 x 3/8	60	17000	705271	2-1/2 x 1/2	150	15000	705334
1 x 1	150	-	705194	2 x 3/8	80	17000	705272	2-1/2 x 1/2	180	15000	705335
1 x 1	180	-	705195	2 x 3/8	120	17000	705273	2-1/2 x 1/2	240	15000	705336
1 x 1	240	-	705196	2 x 3/8	150	17000	705274	2-1/2 x 1/2	320	15000	705337
1 x 1	320	-	705197	2 x 3/8	180	17000	705275	2-1/2 x 3/4	40	15000	705340
1-3/16 x 3/16	60	25000	705201	2 x 3/8	240	17000	705276	2-1/2 x 3/4	60	15000	705341
1-3/16 x 3/16	80	25000	705202	2 x 3/8	320	17000	705277	2-1/2 x 3/4	80	15000	705342
1-3/16 x 3/16	120	25000	705203	2 x 1/2	40	17000	705280	2-1/2 x 3/4	120	15000	705343
1-3/16 x 3/16	150	25000	705204	2 x 1/2	60	17000	705281	2-1/2 x 3/4	150	15000	705344
1-3/16 x 3/16	180	25000	705205	2 x 1/2	80	17000	705282	2-1/2 x 3/4	180	15000	705345
1-3/16 x 3/16	240	25000	705206	2 x 1/2	120	17000	705283	2-1/2 x 3/4	240	15000	705346
1-3/16 x 3/16	320	25000	705207	2 x 1/2	150	17000	705284	2-1/2 x 3/4	320	15000	705347
1-3/16 x 3/8	40	25000	705210	2 x 1/2	180	17000	705285	2-1/2 x 1	40	15000	705350
1-3/16 x 3/8	60	25000	705211	2 x 1/2	240	17000	705286	2-1/2 x 1	60	15000	705351
1-3/16 x 3/8	80	25000	705212	2 x 1/2	320	17000	705287	2-1/2 x 1	80	15000	705352
1-3/16 x 3/8	120	25000	705213	2 x 5/8	40	17000	705290	2-1/2 x 1	120	15000	705353
1-3/16 x 3/8	150	25000	705214	2 x 5/8	60	17000	705291	2-1/2 x 1	150	15000	705354
1-3/16 x 3/8	180	25000	705215	2 x 5/8	80	17000	705292	2-1/2 x 1	180	15000	705355
1-3/16 x 3/8	240	25000	705216	2 x 5/8	120	17000	705293	2-1/2 x 1	240	15000	705356
1-3/16 x 3/8	320	25000	705217	2 x 5/8	150	17000	705294	2-1/2 x 1	320	15000	705357
1-1/2 x 1/2	40	18000	705220	2 x 5/8	180	17000	705295	2-1/2 x 1-1/2	40	15000	705360
1-1/2 x 1/2	60	18000	705221	2 x 5/8	240	17000	705296	2-1/2 x 1-1/2	60	15000	705361
1-1/2 x 1/2	80	18000	705222	2 x 5/8	320	17000	705297	2-1/2 x 1-1/2	80	15000	705362
1-1/2 x 1/2	120	18000	705223	2 x 3/4	40	17000	705300	2-1/2 x 1-1/2	120	15000	705363
1-1/2 x 1/2	150	18000	705224	2 x 3/4	60	17000	705301	2-1/2 x 1-1/2	150	15000	705364
1-1/2 x 1/2	180	18000	705225	2 x 3/4	80	17000	705302	2-1/2 x 1-1/2	180	15000	705365
1-1/2 x 1/2	240	18000	705226	2 x 3/4	120	17000	705303	2-1/2 x 1-1/2	240	15000	705366
1-1/2 x 1/2	320	18000	705227	2 x 3/4	150	17000	705304	2-1/2 x 1-1/2	320	15000	705367
1-1/2 x 5/8	60	18000	705231	2 x 3/4	180	17000	705305	3 x 1/2	40	14000	705370
1-1/2 x 5/8	80	18000	705232	2 x 3/4	240	17000	705306	3 x 1/2	60	14000	705371
1-1/2 x 5/8	120	18000	705233	2 x 3/4	320	17000	705307	3 x 1/2	80	14000	705372
1-1/2 x 5/8	150	18000	705234	2 x 1	40	17000	705310	3 x 1/2	120	14000	705373
1-1/2 x 5/8	180	18000	705235	2 x 1	60	17000	705311	3 x 1/2	150	14000	705374
1-1/2 x 3/4	40	18000	705240	2 x 1	80	17000	705312	3 x 1/2	180	14000	705375
1-1/2 x 3/4	60	18000	705241	2 x 1	120	17000	705313	3 x 1/2	240	14000	705376
1-1/2 x 3/4	80	18000	705242	2 x 1	150	17000	705314	3 x 1/2	320	14000	705377
1-1/2 x 3/4	120	18000	705243	2 x 1	180	17000	705315	3 x 3/4	40	14000	705390
1-1/2 x 3/4	150	18000	705244	2 x 1	240	17000	705316	3 x 3/4	60	14000	705391
1-1/2 x 3/4	180	18000	705245	2 x 1	320	17000	705317	3 x 3/4	80	14000	705392
				2 x 1-1/2	40	17000	705320	3 x 3/4	120	14000	705393