

## Quick Clamping Lathe Chucks

Cast Iron & Steel – Solid Jaws – 3-Jaw & 6-Jaw

For Drill and End Mill Sharpening



- Lever scroll chuck designed for grinding twist drills and other cutting tools
- Fine adjustment in sizes 5" and 6" to the required concentricity by means of 4 radially arranged adjusting screws



3-Jaw – Cast Iron – Series 3266

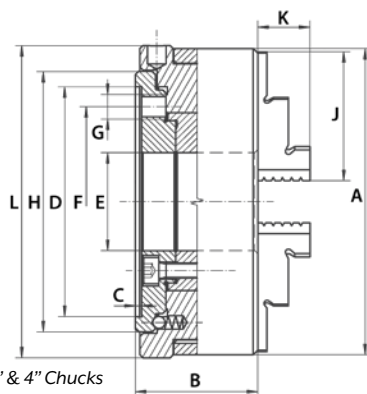

3" & 4" Chucks

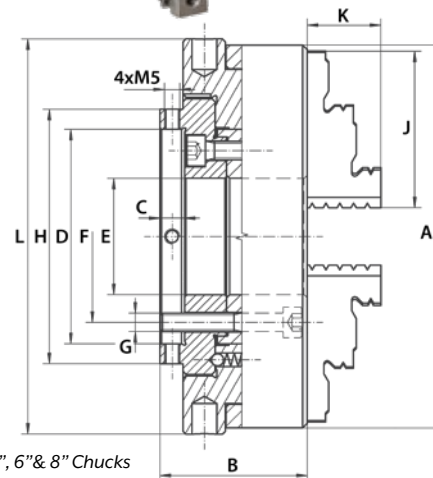

5", 6" & 8" Chucks

**Standard Accessories**

- 1 set of hard solid ID jaws
- 1 set of hard solid OD jaws
- 1 operating lever

A (Inch)	B (Inch)	C (Inch)	D (Inch)	E (Inch)	F (Inch)	G	H (Inch)	J (Inch)	K (Inch)	L (Inch)	Length of Lever (Inch)	Weight (lbs)	Code
3.15	1.38	0.06	1.89	0.94	1.54	3 x M6	2.05	1.30	0.51	3.23	3.94	2.43	355289
3.94	1.57	0.08	2.95	1.26	1.77	3 x M6	3.35	1.65	0.67	4.02	4.92	7.05	355290
4.92	1.89	0.31	2.76	1.50	2.20	3 x M6	3.27	2.01	0.79	5.08	6.30	8.82	355291
6.30	2.05	0.31	3.09	2.05	2.56	3 x M6	3.78	2.76	1.30	6.46	7.87	16.09	355292

6-Jaw – Steel – Series 3866

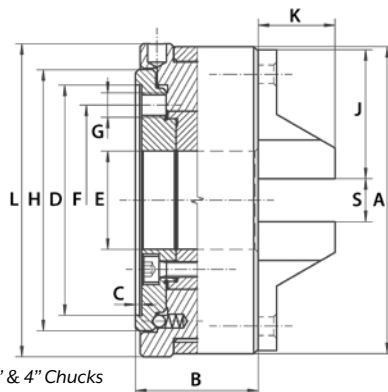

3" & 4" Chucks

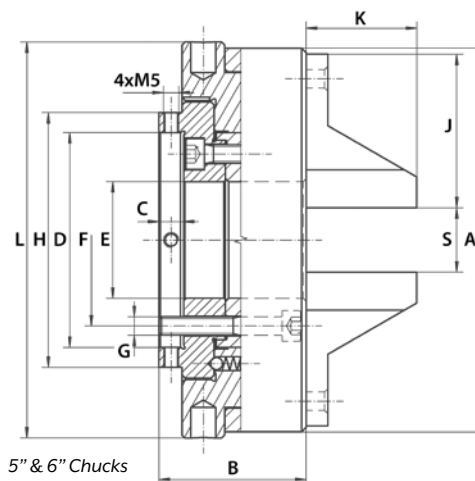

5" & 6" Chucks

**Standard Accessories**

- 1 set of hard solid jaws
- 1 operating lever

A (Inch)	B (Inch)	C (Inch)	D (Inch)	E (Inch)	F (Inch)	G	H (Inch)	J (Inch)	K (Inch)	L (Inch)	S (Inch)	Length of Lever (Inch)	Weight (lbs)	Code
3.15	1.38	0.06	1.89	0.94	1.54	3 x M6	2.05	1.38	0.87	3.23	0.04 - 0.91	3.94	4.41	355293
3.94	1.57	0.08	2.95	1.26	2.44	3 x M8	3.35	1.65	0.98	4.02	0.06 - 1.22	4.92	6.17	355294
4.92	1.89	0.31	2.76	1.50	2.20	3 x M6	3.27	1.97	1.42	5.08	0.08 - 1.46	6.30	8.82	355295
6.30	2.05	0.31	3.09	2.05	2.56	3 x M6	3.78	2.28	1.42	6.46	0.12 - 2.01	7.87	15.43	355296