

Indicator Magnetic Backs

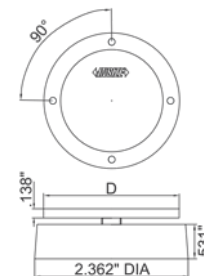

For use with Electronic/ Dial Indicators	Ø D	INSIZE No.	Code
INSIZE series 2103 INSIZE series 2104 INSIZE series 2109 INSIZE series 2112 INSIZE series 2113 INSIZE series 2115 INSIZE series 2117 INSIZE series 2118	2.028	7331-M1	877211
INSIZE series 2307	2.126	7331-M2	877212



Dial Test Indicators



- Meets DIN2270 standards
- Jeweled bearing
- Carbide contact point
- Two measuring directions
- Anti magnetic body
- Supplied with two clamps: diameter Ø4mm and Ø8mm

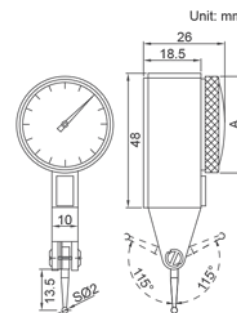

Range (mm)	Graduation (mm)	Accuracy	Hysteresis	Dial Reading	ØA (mm)	L (mm)	INSIZE No.	Code
0.8	0.01	13µm	3µm	0-40-0	30	13.5	2380-08	816168

Granite Dial Indicator Stands

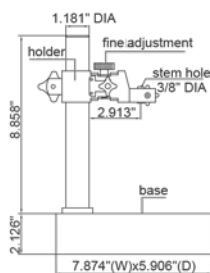

- Vertical travel of holder: 5.906"
- Fine adjustment range .079"
- Supplied with dust cover

Applicable Holding Stem	Base	INSIZE No.	Code
Ø3/8"	Flatness 98µin	6866-150E	877397

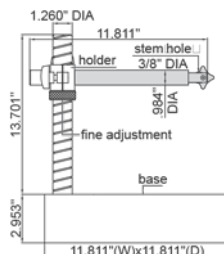

- Vertical travel of holder: 9.843"
- Fine adjustment range: entire stroke
- Supplied with dust cover

Applicable Holding Stem	Base	INSIZE No.	Code
Ø3/8"	Flatness 110µin	6867-250E	877398