

Non-Rotating Spindle Universal Micrometers

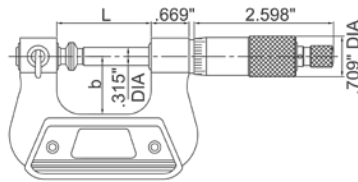

MICROMETERS



Anvil/spindle tip (included)

Flat	.256\"/>
Spherical	$\frac{S}{R}$.256\"/>
Spline	.079\"/>
Disk	.472\"/>
Blade	.028\"/>
Knife-edge	.014\"/>
Point	.012\"/>

- Graduation: 0.0001"
- Non-rotating spindle
- Ratchet stop
- Supplied with 7 pair of anvil/spindle tips
- Supplied in fitted storage case

Range (Inch)	Accuracy (Inch)	L (Inch)	b (Inch)	INSIZE No.	Code
0-1	±0.00015	1.654	1.024	3280-1	281607

Inside Micrometers

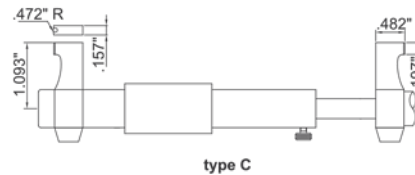
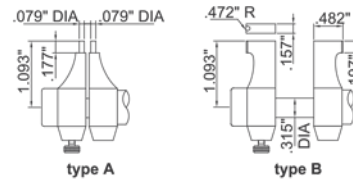
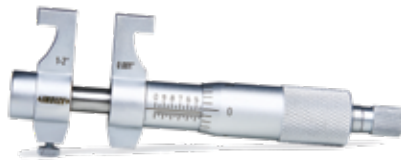

- Graduation: 0.001"
- Ratchet stop
- Carbide measuring faces
- Supplied in fitted storage case

Range (Inch)	Type	Setting Ring (Inch)	Accuracy (Inch)	INSIZE No.	Code
0.2-1.2	A	Ø 0.2 included	±0.0003	3220-1	281962
1-2	B	Ø 1 included	±0.00035	3220-2	281963
2-3	B	Ø 2 optional	±0.00035	3220-3	281964
3-4	C	Ø 3 optional	±0.0004	3220-4	281965

Electronic Inside Micrometers

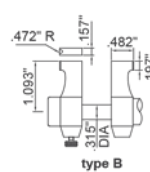
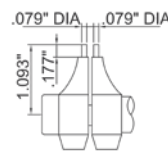

- Resolution: 0.00005"/0.001mm
- Button function: on/off, set, inch/mm, ABS/INC
- Data output
- Battery LR44
- Auto power off
- Ratchet stop
- Carbide measuring faces
- 0.2" diameter setting ring included
- Supplied in fitted storage case

Range (Inch/mm)	Type	Accuracy (Inch)	INSIZE No.	Code
0.2-1.2/5-30	A	±0.0002	3520-30E	281970
1-2/25-50	B	±0.00025	3520-50E	877308