

Tool Holder Bushings

CNC Bushings – Black Oxide Finish – Types C, CV, B, DD, J & Z (continued)

Type B

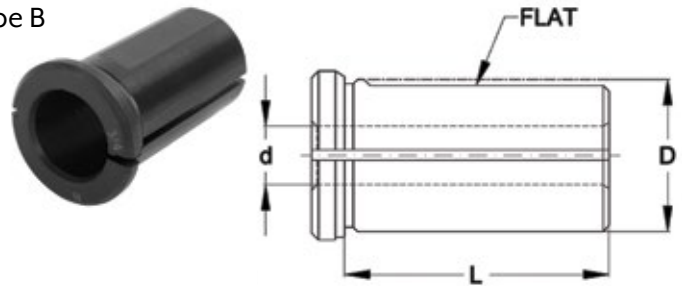

- B bushings have splits and flats providing strong gripping of the tool shanks

D Outside Diameter (Inch)	d Inside Diameter (Inch)	L Length Under Head (Inch)	Code
1	1/2	1-3/4	310832
1	5/8	1-3/4	310833
1	3/4	1-3/4	310834
3 Piece Set – 1/2" to 3/4"			300844
1-1/4	3/8	2-1/8	310700
1-1/4	1/2	2-1/8	310835
1-1/4	5/8	2-1/8	310701
1-1/4	3/4	2-1/8	310836
1-1/4	7/8	2-1/8	310702
1-1/4	1	2-1/8	310837
6 Piece Set – 3/8" to 1"			300845
1-1/2	3/8	2-1/2	310703
1-1/2	1/2	2-1/2	310838
1-1/2	5/8	2-1/2	310704
1-1/2	3/4	2-1/2	310839
1-1/2	7/8	2-1/2	310705
1-1/2	1	2-1/2	310840
1-1/2	1-1/4	2-1/2	310706
7 Piece Set – 3/8" to 1-1/4"			300846
1-3/4	1/2	3	310707
1-3/4	5/8	3	310708
1-3/4	3/4	3	310709
1-3/4	7/8	3	310710
1-3/4	1	3	310711

D Outside Diameter (Inch)	d Inside Diameter (Inch)	L Length Under Head (Inch)	Code
1-3/4	1-1/4	3	310712
1-3/4	1-1/2	3	310713
7 Piece Set – 1/2" to 1-1/2"			300847
2	1/2	3-1/2	310714
2	5/8	3-1/2	310715
2	3/4	3-1/2	310716
2	7/8	3-1/2	310717
2	1	3-1/2	310718
2	1-1/4	3-1/2	310719
2	1-1/2	3-1/2	310720
2	1-3/4	3-1/2	310721
8 Piece Set – 1/2" to 1-3/4"			300848
2-1/2	1/2	4	310722
2-1/2	5/8	4	310723
2-1/2	3/4	4	310724
2-1/2	7/8	4	310725
2-1/2	1	4	310726
2-1/2	1-1/4	4	310727
2-1/2	1-1/2	4	310728
2-1/2	1-3/4	4	310729
2-1/2	2	4	310730
2-1/2	2-1/4	4	310731
10 Piece Set – 1/2" to 2-1/4"			300849

Type DD

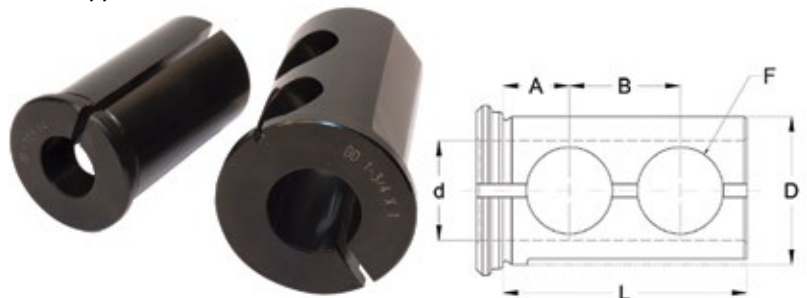

- DD bushings combine Type B split bushings and Type J with the set screw holes allowing this bushing to be used as either Type B or Type J
- Each bushing has a split, two or four holes and a flat

D Outside Diameter (Inch)	d Inside Diameter (Inch)	L Length Under Head (Inch)	A (Inch)	B (Inch)	F (Inch)	Code
1-1/2	3/8	2-1/2	11/16	1-1/8	7/8	310779
1-1/2	1/2	2-1/2	11/16	1-1/8	7/8	310780

D Outside Diameter (Inch)	d Inside Diameter (Inch)	L Length Under Head (Inch)	A (Inch)	B (Inch)	F (Inch)	Code
1-1/2	5/8	2-1/2	11/16	1-1/8	7/8	310781
1-1/2	3/4	2-1/2	11/16	1-1/8	7/8	310782