

Parting Tool Holders

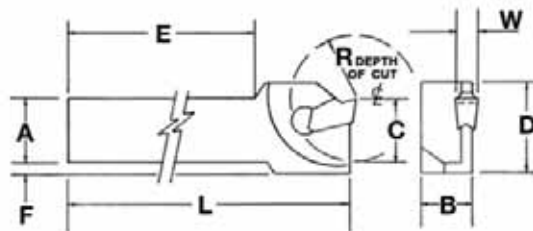

Right Hand shown



Left Hand

A (Inch)	B (Inch)	C (Inch)	D (Inch)	E (Inch)	F (Inch)	L (Inch)	Depth of Cut R.Max. (Inch)	Insert Width Reference (Inch)	Code
3/8	3/8	3/8	3/4	2-3/4	3/16	3-3/8	1/2	0.087 + 0.094	577013
15/32	3/8	15/32	3/4	3-37/64	5/32	4-5/16	19/32	0.087 + 0.094	577015
5/8	3/8	5/8	3/4	3-37/64	0	4-5/16	19/32	0.087 + 0.094	577017
5/8	1/2	5/8	1	3-29/64	11/64	4-5/16	9/16	0.120	577019
5/8	1/2	5/8	1	3-29/64	11/64	4-5/16	5/8	0.160	577021
3/4	1/2	3/4	1	3-29/64	0	4-5/16	5/8	0.087 + 0.094	577027
3/4	1/2	3/4	1	3-29/64	1/16	4-5/16	5/8	0.160	577023
3/4	1/2	3/4	1	4-7/16	3/64	4-5/16	5/8	0.187 + 0.200	577025

Right Hand

A (Inch)	B (Inch)	C (Inch)	D (Inch)	E (Inch)	F (Inch)	L (Inch)	Depth of Cut R.Max. (Inch)	Insert Width Reference (Inch)	Code
3/8	3/8	3/8	3/4	2-3/4	3/16	3-3/8	1/2	0.087 + 0.094	577031
15/32	3/8	15/32	3/4	3-37/64	5/32	4-5/16	19/32	0.087 + 0.094	577033
5/8	3/8	5/8	3/4	3-37/64	0	4-5/16	19/32	0.087 + 0.094	577035
5/8	1/2	5/8	1	3-29/64	11/64	4-5/16	9/16	0.120	577037
5/8	1/2	5/8	1	3-29/64	11/64	4-5/16	5/8	0.160	577039
3/4	1/2	3/4	1	3-29/64	0	4-5/16	5/8	0.087 + 0.094	577045
3/4	1/2	3/4	1	3-29/64	0	4-5/16	5/8	0.120	577047
3/4	1/2	3/4	1	3-29/64	1/16	4-5/16	5/8	0.160	577041
3/4	1/2	3/4	1	4-7/16	3/64	4-5/16	5/8	0.187 + 0.200	577043