

## Universal Lathe Chucks & Accessories



### PS Series – Semi-Steel Body – 3-Jaw & 4-Jaw Self-Centering Chucks

#### 2 Pc. Hard Reversible Jaws

- Semi-steel body, medium duty
- 3 pinion design

#### Each chuck is provided with:

- 1 set of hard master jaws
- 1 set of hard top reversible jaws
- 1 chuck wrench
- 1 set of mounting bolts
- 2 hex keys
- Eye bolts with 10-32" chucks
- Adapters required for plain back mounting

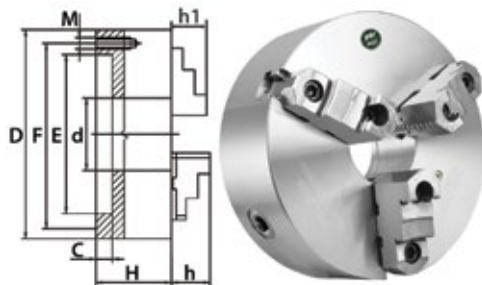

#### PS Series - Plain Back Mounting Specifications

Chuck Diameter (Inch)	RPM Max	M Thread	L (Inch)	No. of Bolts
5	3200	M8 x 1.25	0.98	3
6	3000	M10 x 1.5	0.98	6
8	2500	M10 x 1.5	0.98	6
10	2000	M12 x 1.75	1.18	6
12	1500	M16 x 2	1.18	6
16	1000	M16 x 2	1.57	6
20	700	M16 x 2	1.57	6
25	500	M16 x 2	1.97	6
32	300	1-8	5.96	6

#### Plain Back Mounting – 3-Jaw Chucks

Chuck Diameter (Inch)	d Hole (Inch)	Maximum Hole Enlargements (Inch)	Model	C (Inch)	E (Inch)	F (Inch)	H (Inch)	h (Inch)	h1 (Inch)	Code
5	1.26	1.35	PS3-5"A	0.16	3.74	4.25	2.20	1.57	0.79	356373
6	1.65	1.93	PS3-6"A	0.16	4.92	5.51	2.54	1.69	1.26	410009
8	2.17	2.82	PS3-8"A	0.16	6.30	6.93	2.95	1.77	1.14	410010
10	2.99	3.58	PS3-10"A	0.20	7.87	8.82	3.35	2.09	1.34	410003
12	4.06	4.33	PS3-12"A	0.20	10.24	11.26	3.70	2.24	1.69	410007
16	5.35	5.75	PS3-16"A	0.20	12.99	14.25	4.13	2.69	2.16	410008
20	7.48	8.35	PS3-20"A	0.24	16.54	18.03	4.53	3.50	2.20	356374
25	9.92	12.05	PS3-25"A	0.28	21.46	23.07	5.16	3.46	2.76	356375
32	12.60	-	PS3-32"A	0.79	17.72	14.50	6.26	3.46	2.76	356376

#### Camlock Mounting – 3-Jaw Chucks

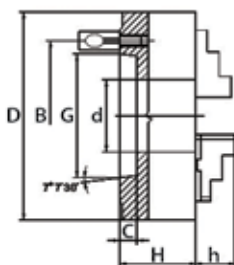

#### PS Series - Camlock Mounting Specifications

Chuck Diameter (Inch)	RPM Max	Weight (lbs)	Taper Size	Camlock Stud Diameter (Inch)	Camlock Stud Thread	No. of Studs
5	3200	11	DI-4	0.62	M10 x 1.0	3
6	3000	20	DI-3	0.56	M10 x 1.0	3
6	3000	20	DI-4	0.62	M10 x 1.0	3
8	2500	42	DI-3	0.56	M10 x 1.0	3
8	2500	42	DI-4	0.62	M10 x 1.0	3
8	2500	42	DI-5	0.75	M12 x 1.0	6
8	2500	42	DI-6	0.87	M16 x 1.5	6
10	2000	71	DI-5	0.75	M12 x 1.0	6
10	2000	71	DI-6	0.87	M16 x 1.5	6
10	2000	71	DI-8	1.00	M20 x 1.5	6
12	1500	112	DI-6	0.87	M16 x 1.5	6
12	1500	112	DI-8	1.00	M20 x 1.5	6
12	1500	112	DI-11	1.19	M22 x 1.5	6
16	1000	223	DI-6	0.87	M16 x 1.5	6
16	1000	223	DI-8	1.00	M20 x 1.5	6
16	1000	223	DI-11	1.19	M22 x 1.5	6
20	700	331	DI-8	1.00	M20 x 1.5	6
20	700	331	DI-11	1.19	M22 x 1.5	6
25	500	604	DI-11	1.19	M22 x 1.5	6