

## Spade Drill Holders



### Short Length – Straight Shank – Straight Flute (continued)

Series	Shank Diameter (Inch)	A Drill Insert Range (Inch)	B Maximum Drill Depth (Inch)	C Flute Length (Inch)	D Reference Length (Inch)	E Overall Length (Inch)	F Shank Length (Inch)	G Coolant Hole Thread Size (NPT)	Code
1.5	3/4	55/64 – 15/16	2-5/8	3-7/8	4-1/64	6-7/8	3	1/8	549568
1.5	1	55/64 – 15/16	2-5/8	3-7/8	4-1/64	6-7/8	3	1/8	549569
2	1	31/32 – 1-3/8	3-3/8	4-1/2	4-41/64	8	3-1/2	1/8	549570
2	1-1/4	31/32 – 1-3/8	3-3/8	4-1/2	4-41/64	8	3-1/2	1/8	549571
2.5	1	1-3/16 – 1-3/8	3-3/8	4-1/2	4-41/64	8	3-1/2	1/8	549572
2.5	1-1/4	1-3/16 – 1-3/8	3-3/8	4-1/2	4-41/64	8	3-1/2	1/8	549573
3	1-1/4	1-13/32 – 1-7/8	4-3/4	6	6-3/16	10	4	1/4	549574
3	1-1/2	1-13/32 – 1-7/8	4-3/4	6	6-3/16	10	4	1/4	549575
4	1-1/2	1-29/32 – 2-9/16	5-1/8	6-1/2	6-11/16	10-1/2	4	1/4	549576
4	1-3/4	1-29/32 – 2-9/16	5-1/8	6-1/2	6-11/16	10-1/2	4	1/4	549577
5-6	2	2-1/2 – 3-1/2	6-3/4	8-1/2	8-3/4	12-1/2	4	1/2	549578
7-8	3	3-17/32 – 4-1/2	6-3/4	8-7/8	9-1/8	13-7/8	5	1/2	549579

### Intermediate Length – Straight Shank – Straight Flute

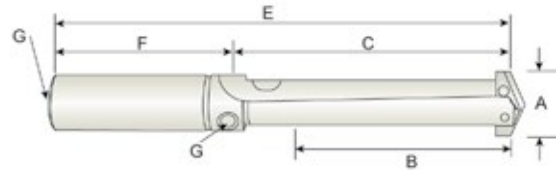

Series	Shank Diameter (Inch)	A Drill Insert Range (Inch)	B Maximum Drill Depth (Inch)	C Flute Length (Inch)	E Overall Length (Inch)	F Shank Length (Inch)	G Coolant Hole Thread Size (NPT)	Code
1	1	45/64 – 15/16	4-5/8	5-7/8	8-7/8	3	1/8	549582
1.5	1	55/64 – 15/16	4-5/8	5-7/8	8-7/8	3	1/8	549583
2	1-1/4	31/32 – 1-3/8	5-3/8	6-1/2	10	3-1/2	1/8	549584
2.5	1-1/4	1-3/16 – 1-3/8	5-3/8	6-1/2	10	3-1/2	1/8	549585
3	1-1/2	1-13/32 – 1-7/8	6-1/2	7-3/4	11-3/4	4	1/4	549586

### Standard Length – Straight Shank – Straight Flute

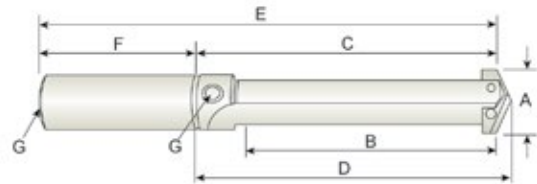

Series	Shank Diameter (Inch)	A Drill Insert Range (Inch)	B Maximum Drill Depth (Inch)	C Flute Length (Inch)	D Reference Length (Inch)	E Overall Length (Inch)	F Shank Length (Inch)	G Coolant Hole Thread Size (NPT)	Code
Y	3/4	3/8 – 27/64	2-3/8	3-5/32	3-1/4	5-17/32	2-3/8	1/8	549603
Z	3/4	7/16 – 1/2	2-3/8	3-5/32	3-1/4	5-17/32	2-3/8	1/8	549604
0	3/4	33/64 – 11/16	2-1/2	3-5/16	3-27/64	5-11/16	2-3/8	1/8	549587
0.5	3/4	39/64 – 11/16	2-1/2	3-5/16	3-27/64	5-11/16	2-3/8	1/8	549588
1	3/4	45/64 – 15/16	6-5/8	7-7/8	8-1/64	10-7/8	3	1/8	549589
1	1	45/64 – 15/16	6-5/8	7-7/8	8-1/64	10-7/8	3	1/8	549590
1.5	3/4	55/64 – 15/16	6-5/8	7-7/8	8-1/64	10-7/8	3	1/8	549591
1.5	1	55/64 – 15/16	6-5/8	7-7/8	8-1/64	10-7/8	3	1/8	549592
2	1	31/32 – 1-3/8	7-3/8	8-1/2	8-41/64	12	3-1/2	1/8	549593
2	1-1/4	31/32 – 1-3/8	7-3/8	8-1/2	8-41/64	12	3-1/2	1/8	549594