



Precision Lathe Chucks

Steel – 2-Piece Jaws – 3-Jaw & 6-Jaw Set Tru (continued)

Back Plates for Set Tru Chucks

- Fully machined
- Set Tru chucks only take Set Tru back plates

Type A – Series 8215

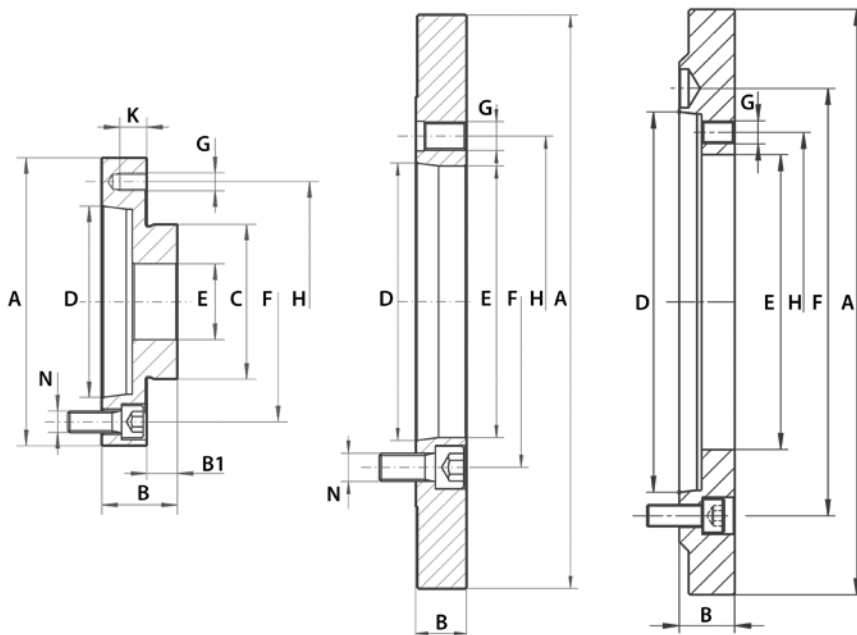

Chuck Dia. (Inch)	Taper Size	Sketch Ref.	A (Inch)	B (Inch)	B1 (Inch)	C (Inch)	D (Inch)	E (Inch)	F (Inch)	G	H (Inch)	K (Inch)	Weight (lbs)	Code
6	5	I	6.30	1.46	0.63	3.39	3.25	1.65	4.13	M10	5.51	0.83	6.83	355147
8	5	I	7.87	1.30	0.67	4.33	3.25	2.17	4.13	M10	6.93	0.63	9.26	355148
8	6	I	7.87	1.77	0.67	4.33	4.19	2.17	5.25	M10	6.93	1.10	13.67	355149
10	5	I	9.84	1.50	0.75	5.71	3.25	2.99	4.13	M12	8.82	0.75	17.20	355150
10	6	I	9.84	1.50	0.75	5.71	4.19	2.99	5.25	M12	9.82	0.75	17.42	355151
10	8	I	9.84	1.81	0.75	5.71	5.50	2.99	6.75	M12	8.82	1.02	20.28	355152
12	6	I	12.40	1.50	0.75	7.09	4.19	4.06	5.25	M16	11.26	0.75	27.12	355153
12	8	I	12.40	1.81	0.75	7.09	5.50	4.06	6.75	M16	11.26	1.06	35.27	355154
12	11	I	12.40	2.17	0.75	7.09	7.75	4.06	9.25	M16	11.26	1.42	41.23	355155
16	8	II	11.75	1.46	-	11.75	5.50	5.35	6.75	M16	6.75	1.14	28.22	355156
16	11	II	11.75	1.89	-	11.75	7.75	5.35	9.25	M16	6.75	1.06	35.71	355157
20	8	II	16.02	1.42	-	16.02	5.50	5.35	6.75	M20	9.25	1.42	69.45	355158
20	11	II	16.02	1.42	-	16.02	7.75	7.59	9.25	M20	9.25	1.42	60.85	355159
20	15	II	16.02	2.05	-	16.02	11.25	7.48	13.00	M20	9.25	2.05	76.28	355160
25	8	II	16.02	1.42	-	16.02	5.50	5.35	6.75	M20	13.00	1.42	69.45	355161
25	11	II	16.02	1.42	-	16.02	7.75	7.59	9.25	M20	13.00	1.42	60.85	355162
25	15	II	16.02	2.05	-	16.02	11.25	9.92	13.00	M20	13.00	2.05	65.26	355163

LATHE CHUCKS & ACCESSORIES