

Universal Machining Chucks

4-Jaw – Vertical

- Parts are gripped firmly by the formed jaws, ensuring high precision (deviation within 0.03mm)
- Large workpieces can be held tight with the low profile vise body
- Handle is set on the face and does not interfere with the table. A number of chucks can be used together
- Soft jaws available

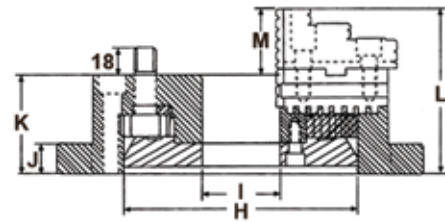
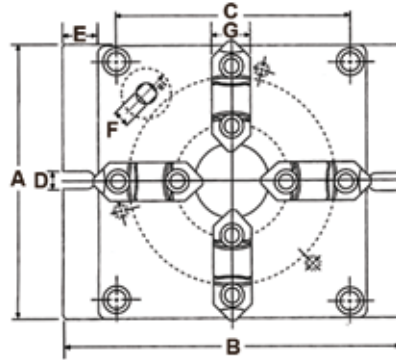
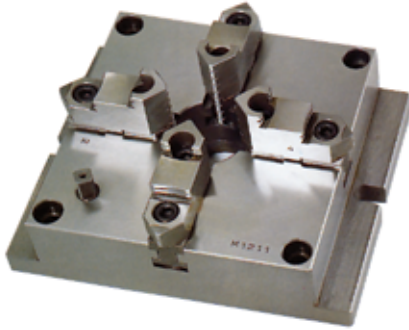

A (mm)	B (mm)	C (mm)	D (mm)	E (mm)	F (mm)	G (mm)	H (mm)	I (mm)	J (mm)	K (mm)	L (mm)	M (mm)	Code
165	215	143	13	25	12	26	130	40	18	57	97	40	302706
250	310	218	18	60	-	32	200	70	-	-	-	-	302710

Universal Tilting Rotary Table

- Accurate and solidly designed table for use on milling, boring and other machine tools
- Allows indexing, facing and other work to be carried out rapidly with extreme precision
- Tilting range 90° from horizontal to vertical position, one rotation of handle equals 3°, five minutes tilting reading
- 10 second Vernier scale
- Table dial one minute graduations
- Fast indexing: location pin in 24 holes (15° ensures accurate spacing)
- Minimum set-up time
- Rugged construction

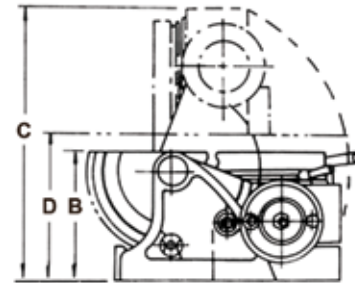
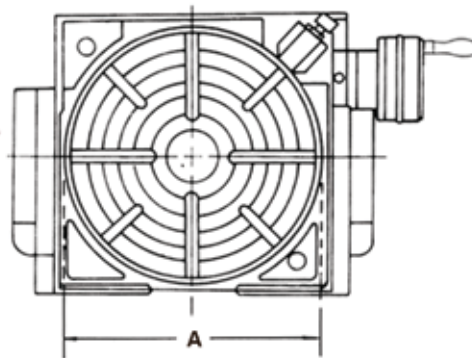
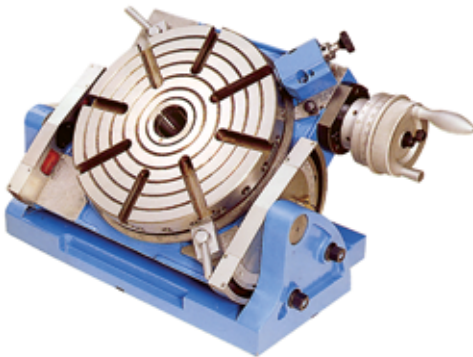

A Table Diameter (mm)	B Table Height (Horizontal) (mm)	C Overall Table Height (Vertical) (mm)	Center Hole	D Center Height (Vertical) (mm)	Direct Indexing	Gear Ratio	Approximate Weight (kg)	Code
300	185	370	MT3	208	24-div.	90:1	102	242130

Accessories sold separately

Tail Stock

Code
242127

Dividing Plates

Code
242132