



## Universal Lathe Chucks

Cast Iron – 2-Piece Jaws – 3-Jaw Self-Centering

Plain Back – Series 3205

- Cast iron
- Plain back (Back plates required)
- Ground working surfaces

**Standard Accessories:**

- 1 set of hard top jaws
- 1 set of hard master jaws
- 1 wrench
- 1 hex key

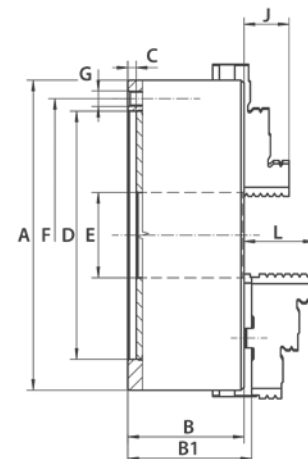

See 322 for Clamping Ranges

A (Inch)	B (Inch)	B1 (Inch)	C (Inch)	D H7 (Inch)	E (Inch)	F (Inch)	G	J (Inch)	L (Inch)	Weight (lbs)	Code
4.92	2.20	2.39	0.16	3.74	1.26	4.25	3 x M8	0.79	1.57	11.02	355000
6.30	2.54	2.73	0.16	4.92	1.65	5.51	6 x M10	1.26	1.69	22.05	355001
7.87	2.95	3.14	0.16	6.30	2.17	6.93	6 x M10	1.14	1.77	38.58	355002
9.84	3.35	3.50	0.20	7.87	2.99	8.82	6 x M12	1.34	2.09	63.93	355003
12.40	3.70	3.90	0.20	10.24	4.06	11.26	6 x M16	1.69	2.24	110.23	355004
15.75	4.13	4.48	0.20	12.99	5.35	14.25	6 x M16	2.17	2.64	187.39	355005
19.69	4.72	5.15	0.20	16.54	7.48	18.03	6 x M16	2.36	3.11	319.67	355006
24.80	5.31	5.76	0.28	21.46	9.92	23.07	6 x M16	2.76	3.43	551.16	355007

Plain Back – Large Diameter – Series 3205

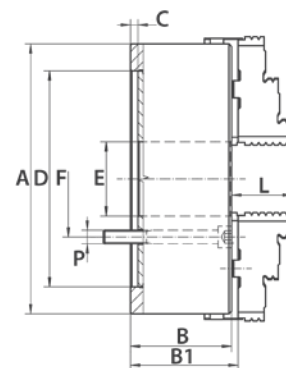

See 322 for Clamping Ranges

A (Inch)	B (Inch)	B1 (Inch)	C (Inch)	D H7 (Inch)	E (Inch)	F (Inch)	P	L (Inch)	Weight (lbs)	Taper (optional)	Code
31.50	5.51	5.96	0.47	14.96	11.08	13.00	6 x M24	3.43	848	8 11 15	355008