

Boring Bars

S-MWLN/L for Negative Trigon WN_ _ Inserts

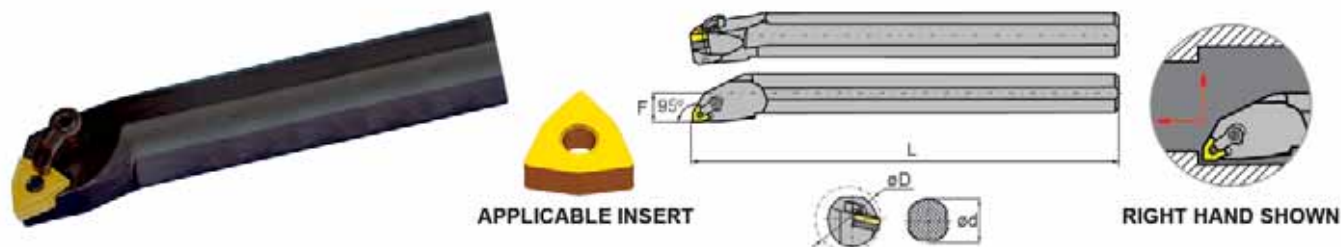

Right Hand

Type S-MWLN/L	Ød (Inch)	L (Inch)	ØD (Inch)	F (Inch)	Applicable Inserts	Code
12-3	0.75	10	0.93	0.500	WN_33	534459
12-4	0.75	10	0.93	0.500	WN_43	534460
16-4	1.00	12	1.28	0.640	WN_43	534461
20-4	1.25	14	1.53	0.785	WN_43	534462
24-4	1.50	14	1.78	0.890	WN_43	534463

Left Hand

Type S-MWLN/L	Ød (Inch)	L (Inch)	ØD (Inch)	F (Inch)	Applicable Inserts	Code
12-3	0.75	10	0.93	0.500	WN_33	534469
12-4	0.75	10	0.93	0.500	WN_43	534470
16-4	1.00	12	1.28	0.640	WN_43	534471
20-4	1.25	14	1.53	0.785	WN_43	534472
24-4	1.50	14	1.78	0.890	WN_43	534473

Accessories

Clamp



For Type S-MWLN/L	Code
12-3	534244
12-4, 16-4, 20-4, 24-4	534240

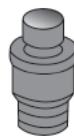

Lock Pin

For Type S-MWLN/L	Code
12-3	534234
12-4, 16-4	534235
20-4, 24-4	534230

Clamp Screw



For Type S-MWLN/L	Code
12-3	534252
12-4, 16-4	534254
20-4, 24-4	534250

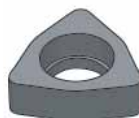

Shim

For Type S-MWLN/L	Code
20-4, 24-4	534275