

## V-Blocks

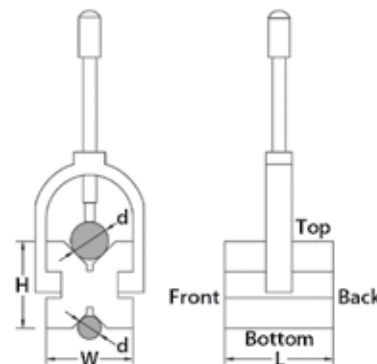

- Hold cylindrical work pieces for inspection and machining
- Hardened to HRC 60±2
- Parallelism of both v-grooves to top and bottom: 0.0002"
- Squareness of both v-grooves to front and back: 0.0002"
- Height difference of a matched pair: 0.0002"
- V-groove on top for large shafts
- V-groove on bottom for small shafts

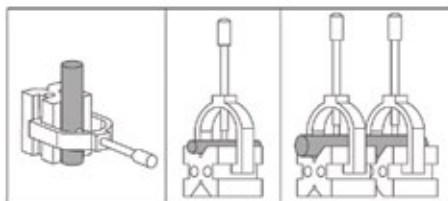

Description	Length x Width x Height (Inch)	d Range of Shafts (Inch)	INSIZE No.	Code
Matched pair	1.97 x 1.57 x 1.57	Ø0.2 to 1.18	6896-11	889455
Matched pair	3.15 x 2.48 x 2.48	Ø0.28 to 2.48	6896-12	889456
Matched pair	3.94 x 3.15 x 3.15	Ø0.28 to 3.15	6896-13	889457

## V-Blocks

### Machined Faces



- Matched and numbered pairs
- V-Blocks provide a useful means of holding cylindrical work for layout, inspection, drilling and machining
- Each pair is accurately machined with 90° V which is centered in true and square and parallel with the base to within .001" (0.03mm)

Width Inch (mm)	Height Inch (mm)	Thickness/Pair Inch (mm)	Capacity Inch	Weight (kg)	Code
2 (51)	1-1/4 (32)	1-7/8 (48)	1-1/4	0.9	390822
3 (76)	2-3/8 (60)	2-5/8 (67)	2-1/2	2.5	390823
4 (102)	2-5/8 (67)	3-1/4 (82)	3	5.0	390824
5 (127)	3-1/8 (79)	4 (102)	3-1/2	8.0	390825
6 (152)	3-1/2 (89)	5 (127)	4	15.0	390826
7 (178)	4-1/2 (114)	6 (152)	5	28.0	390827
8 (203)	5-1/2 (140)	8 (203)	6	44.0	390828
10 (254)	6-1/2 (165)	10 (254)	6-1/2	69.0	390830
12 (305)	8 (203)	12 (305)	7	127.0	390832

## Magnetic V-Blocks

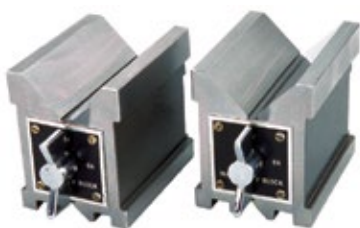

Description	Length x Width x Height (Inch)	Code
Single	4 x 3 x 3-3/4	435541
Matched pair	4 x 3 x 3-3/4	435542

## Magnetic V-Block



- Squareness of V groove to back side .0004"
- Parallelism of V groove to top, bottom, left and right sides .0004"
- Hold cylindrical workpieces for inspection and machining
- Supplied in single piece
- Not hardened
- Not suitable for steel or iron surface, otherwise the magnetic force will be reduced

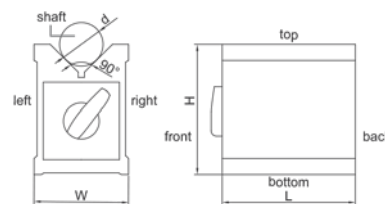

Description	Length x Width x Height (Inch)	d Range of Shafts (Inch)	Magnetic Force (lbf)	INSIZE No.	Code
Single block	2.8 x 2.4 x 2.9	0.24-1.73 Diameter	125	6890-702	283748