

## Screw Jacks & Pads (continued)

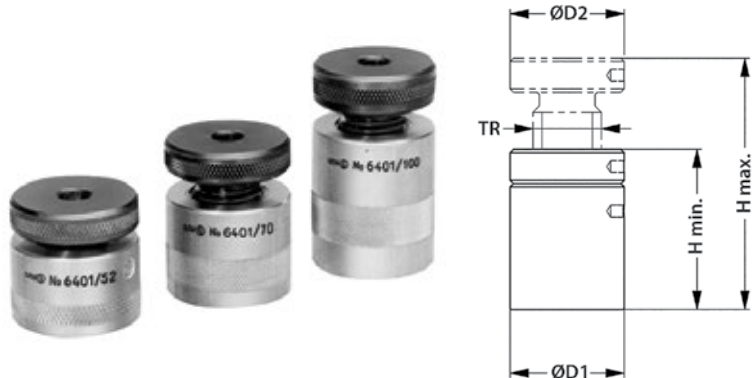

### No. 6401 – Aluminum Screw Jacks



- For clamping and setting
- Screw jack aluminum base with center hole 12mm diameter
- Trapezoidal thread, self-locking spindle with end stop
- Tempered carbon steel with aluminum base 400N/mm<sup>2</sup> tensile strength

**Note:**

- Safeguards machine tables against damage (swarf does not penetrate table - enters aluminum base)
- Useful for all machine tool tables, surface plates and plane tables with precision faces
- Suitable pads are nos. 6440, 6441, and 6442 (below)
- DO NOT ADJUST SCREW JACK UNDER LOAD

Size (mm)	H min. (mm)	H max. (mm)	TR	ØD1 (mm)	ØD2 (mm)	F max. (kN)	Weight (g)	Code
52	42	52	30 x 4	50	50	30	370	405920
70	50	70	30 x 4	50	50	30	430	405922
100	70	100	30 x 4	50	50	30	600	405924

### No. 6430 – Atlas Screw Jack with Counter Nut



- For clamping and setting
- Atlas screw jack with center hole 12mm diameter
- Trapezoidal threaded spindle
- Cast iron body, tempered steel spindle

**Note:**

- Suitable pads are nos. 6440, 6441, 6442, and 6443 (below)
- DO NOT ADJUST SCREW JACK UNDER LOAD

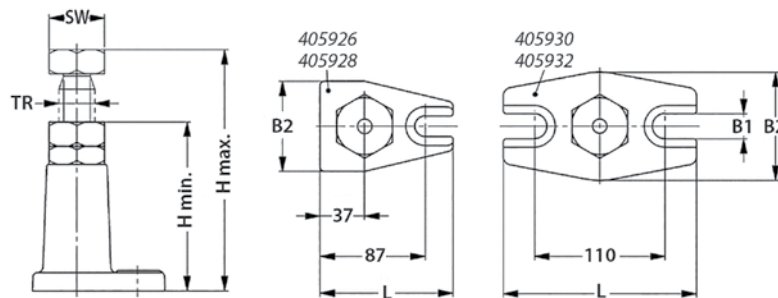

Size (mm)	H min. (mm)	H max. (mm)	TR	B1 (mm)	B2 (mm)	L (mm)	SW (mm)	F max. (kN)	Weight (kg)	Code
140	100	140	30 x 6	18	75	110	46	60	1.8	405926
200	140	200	30 x 6	18	75	110	46	60	2.2	405928
320	200	320	30 x 6	22	90	160	46	40	3.8	406930
550	320	550	30 x 6	22	90	160	46	25	4.9	405932

### Screw Jack Pads



Pad No.	For Screw Jack Model No. ...			Code
	6400	6401	6430	
6440 Ball Pad	•	•	•	405940
6441 V-Pad	•	•	•	405942
6442 Centering Pad	•	•	•	405944
6443 Locating Pad	•	—	•	405948