

## Set Screws

### For End Mill Holders



| Thread          | Code   | Thread         | Code   | Thread           | Code   |
|-----------------|--------|----------------|--------|------------------|--------|
| 1/4-28 x 5/16   | 827105 | 5/8-18 x 33/64 | 827110 | 3/4-16 x 1-3/16  | 827115 |
| 1/4-28 x 1/4    | 827106 | 5/8-18 x 31/64 | 827111 | 3/4-16 x 1-1/4   | 827116 |
| 3/8-24 x 25/64  | 827107 | 3/4-16 x 19/32 | 827112 | 3/4-16 x 1-13/32 | 827117 |
| 7/16-20 x 15/32 | 827108 | 3/4-16 x 5/8   | 827113 | 1-14 x 15/16     | 827118 |
| 9/16-18 x 15/32 | 827109 | 3/4-16 x 45/64 | 827114 |                  |        |

NOTE: Holders 7/8" diameter and above furnished with 2 set screws

## Shell End Mill Arbors

### Caterpillar V-Flange Shank

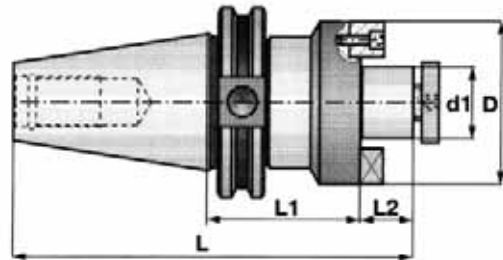

| Taper | d1 (Inch) | L1 (Inch) | L (Inch) | L2 (Inch) | D (Inch) | Code   |
|-------|-----------|-----------|----------|-----------|----------|--------|
| CAT40 | 1/2       | 1-3/8     | 4-5/8    | 9/16      | 1-3/8    | 827549 |
| CAT40 | 3/4       | 1-3/8     | 4-3/4    | 11/16     | 1-49/64  | 827550 |
| CAT40 | 1         | 2-1/16    | 5-7/16   | 11/16     | 2-11/64  | 827551 |
| CAT40 | 1-1/4     | 2-1/8     | 5-1/2    | 11/16     | 2-33/64  | 827552 |
| CAT40 | 1-1/2     | 2-13/32   | 6-1/32   | 15/16     | 3-5/64   | 827553 |
| CAT50 | 1/2       | 1-1/2     | 6-1/16   | 9/16      | 1-3/8    | 827554 |
| CAT50 | 1/2       | 3-1/2     | 8-1/16   | 9/16      | 1-3/8    | 827555 |
| CAT50 | 1/2       | 5-1/2     | 10-1/16  | 9/16      | 1-3/8    | 827556 |
| CAT50 | 3/4       | 1-1/2     | 6-3/16   | 11/16     | 1-49/64  | 827557 |
| CAT50 | 3/4       | 3-1/2     | 8-3/16   | 11/16     | 1-49/64  | 827558 |
| CAT50 | 3/4       | 5-1/2     | 10-3/16  | 11/16     | 1-49/64  | 827559 |
| CAT50 | 1         | 2         | 6-11/16  | 11/16     | 2-11/64  | 827560 |

| Taper | d1 (Inch) | L1 (Inch) | L (Inch) | L2 (Inch) | D (Inch) | Code   |
|-------|-----------|-----------|----------|-----------|----------|--------|
| CAT50 | 1         | 4         | 8-11/16  | 11/16     | 2-11/64  | 827561 |
| CAT50 | 1         | 6         | 10-11/16 | 11/16     | 2-11/64  | 827562 |
| CAT50 | 1-1/4     | 1-1/2     | 6-3/16   | 11/16     | 2-3/4    | 827563 |
| CAT50 | 1-1/4     | 3-1/2     | 8-3/16   | 11/16     | 2-3/4    | 827564 |
| CAT50 | 1-1/4     | 5-1/2     | 10-3/16  | 11/16     | 2-3/4    | 827565 |
| CAT50 | 1-1/2     | 2-13/32   | 7-11/32  | 15/16     | 3-55/64  | 827566 |
| CAT50 | 1-1/2     | 4         | 8-15/16  | 15/16     | 3-55/64  | 827567 |
| CAT50 | 1-1/2     | 6         | 10-15/16 | 15/16     | 3-55/64  | 827568 |
| CAT50 | 2         | 2-13/32   | 7-11/32  | 15/16     | 3-55/64  | 827569 |
| CAT50 | 2         | 4         | 8-15/16  | 15/16     | 3-55/64  | 827570 |
| CAT50 | 2         | 6         | 10-15/16 | 15/16     | 3-55/64  | 827571 |

### BT Shank

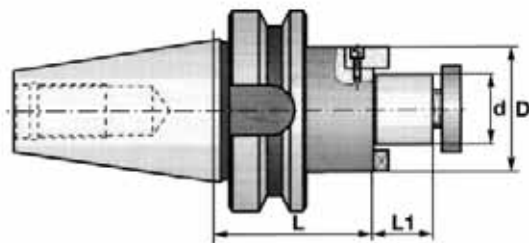

| Taper | d (Inch) | D (Inch) | L (Inch) | L1 (Inch) | Code   |
|-------|----------|----------|----------|-----------|--------|
| BT40  | 1/2      | 1.18     | 1-3/4    | 0.56      | 827600 |
| BT40  | 3/4      | 1.50     | 2        | 0.69      | 827601 |
| BT40  | 1        | 1.73     | 2        | 0.69      | 827602 |
| BT40  | 1-1/4    | 2.08     | 2-1/4    | 0.69      | 827603 |
| BT40  | 1-1/2    | 2.48     | 2-1/4    | 0.92      | 827604 |
| BT50  | 3/4      | 1.50     | 2-1/4    | 0.69      | 827605 |
| BT50  | 1        | 1.73     | 2-1/4    | 0.69      | 827606 |
| BT50  | 1        | 1.73     | 4        | 0.69      | 827607 |
| BT50  | 1        | 1.73     | 6        | 0.69      | 827608 |

| Taper | d (Inch) | D (Inch) | L (Inch) | L1 (Inch) | Code   |
|-------|----------|----------|----------|-----------|--------|
| BT50  | 1-1/4    | 2.08     | 2-1/2    | 0.69      | 827609 |
| BT50  | 1-1/4    | 2.08     | 4        | 0.69      | 827610 |
| BT50  | 1-1/4    | 2.08     | 6        | 0.69      | 827611 |
| BT50  | 1-1/2    | 2.48     | 2-1/2    | 0.92      | 827612 |
| BT50  | 1-1/2    | 2.48     | 4        | 0.92      | 827613 |
| BT50  | 1-1/2    | 2.48     | 6        | 0.92      | 827614 |
| BT50  | 2        | 3.07     | 2-1/2    | 0.94      | 827615 |
| BT50  | 2        | 3.07     | 4        | 0.94      | 827616 |